



## **.15 Montague Road , UB8 1QL**

**£2,424 PCM**

**\*\*STUDENTS\*\***

**4 BEDROOMS - AVAILABLE 17/07/2026**

The rental payments equate to approx £606 per person per month or £140 per person per week excluding bills. UniHomes offer a bills package for £26 per person per week. (Incl Gas, Electric, Water, TV licence and internet) which can be organised through Nupad initially.

COUNCIL TAX BAND E  
EPC E

Nupad offer this excellent FOUR-bedroom house comprising of FOUR FURNISHED BEDROOMS , a LOUNGE, CONSERVATORY, upstairs BATHROOM with separate WC, downstairs SHOWER ROOM AND KITCHEN facilities, outside there is off street parking and rear gardens.

The property is ideal for students at Brunel University. It is also nearby to Uxbridge Town Centre, Heathrow, Stockley Park and the local underground station, which provides further access to Central London.

**.15 Montague Road, UB8 1QL**

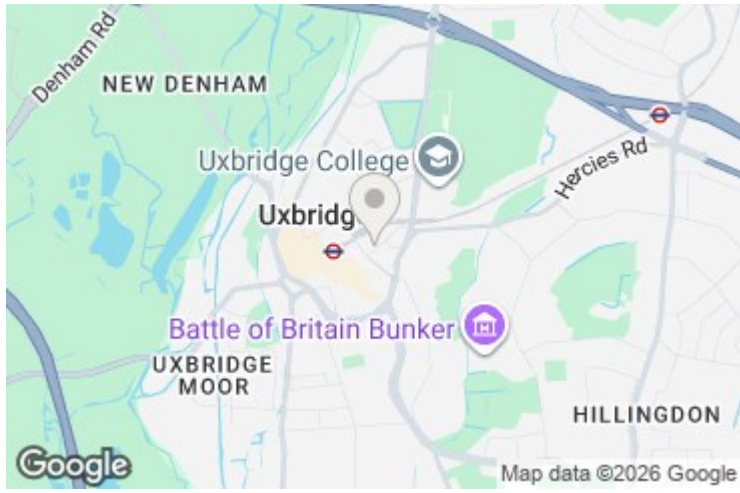

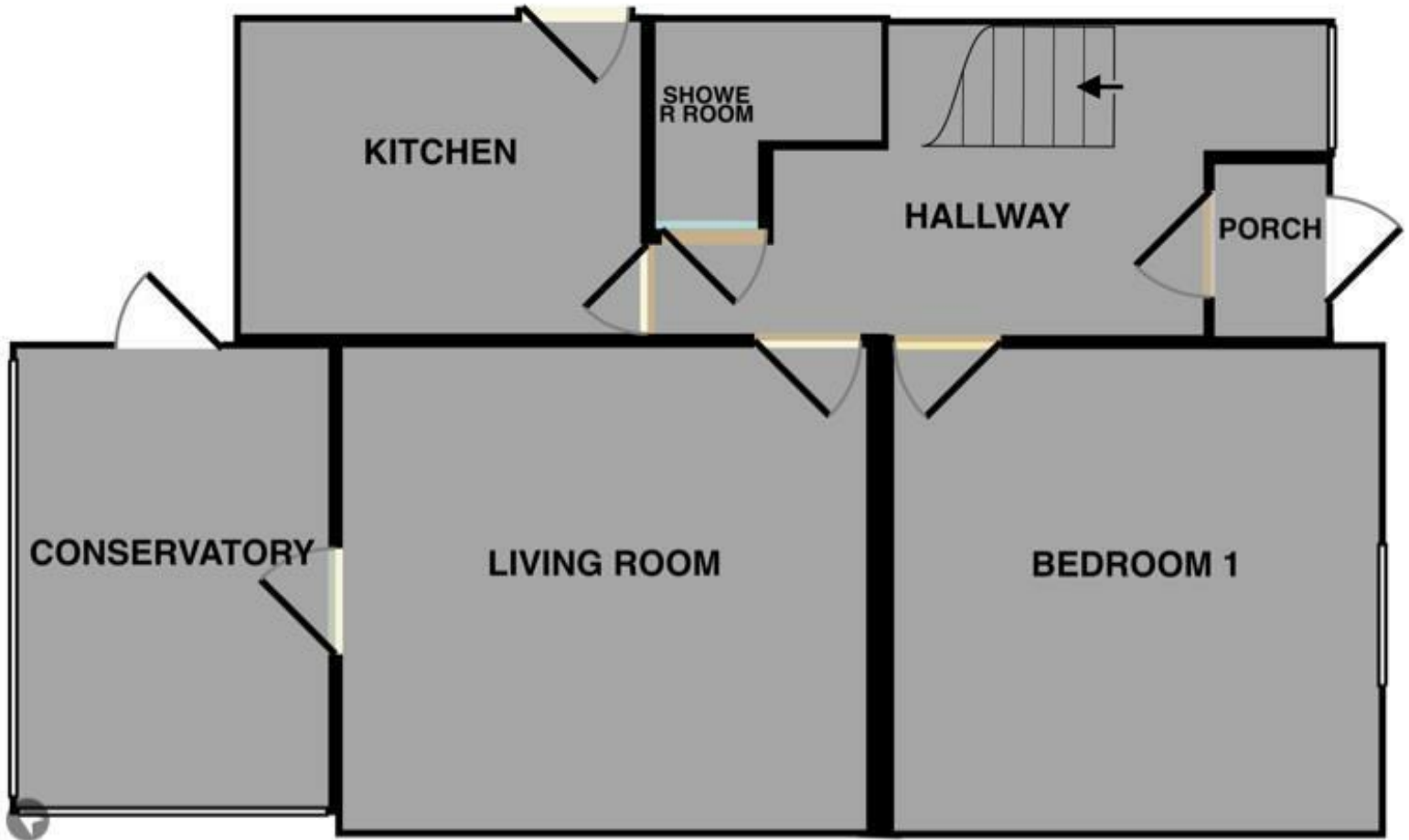

Energy Efficiency Rating		Current	Potential
Very energy efficient - lower running costs			
(92 plus) <b>A</b>			
(81-91) <b>B</b>			
(69-80) <b>C</b>			
(55-68) <b>D</b>			
(39-54) <b>E</b>			
(21-38) <b>F</b>			
(1-20) <b>G</b>			
Not energy efficient - higher running costs			
<b>England &amp; Wales</b>	EU Directive 2002/91/EC	56	57

Environmental Impact (CO <sub>2</sub> ) Rating		Current	Potential
Very environmentally friendly - lower CO <sub>2</sub> emissions			
(92 plus) <b>A</b>			
(81-91) <b>B</b>			
(69-80) <b>C</b>			
(55-68) <b>D</b>			
(39-54) <b>E</b>			
(21-38) <b>F</b>			
(1-20) <b>G</b>			
Not environmentally friendly - higher CO <sub>2</sub> emissions			
<b>England &amp; Wales</b>	EU Directive 2002/91/EC	51	53